

Two Storey

Hamilton

Facade - Modern

Master Builders Association Awards
WINNER - 2008
Custom Built Home \$350,000-\$500,000
Kitchen of the Year Over \$30,000

Housing Industry Association
WINNER - 2008
Custom Built Home Under \$800,000

Finalist - 2008
Custom Built Home Under \$800,000
Custom Built Home Under \$500,000
Bathroom Project Under \$25,000

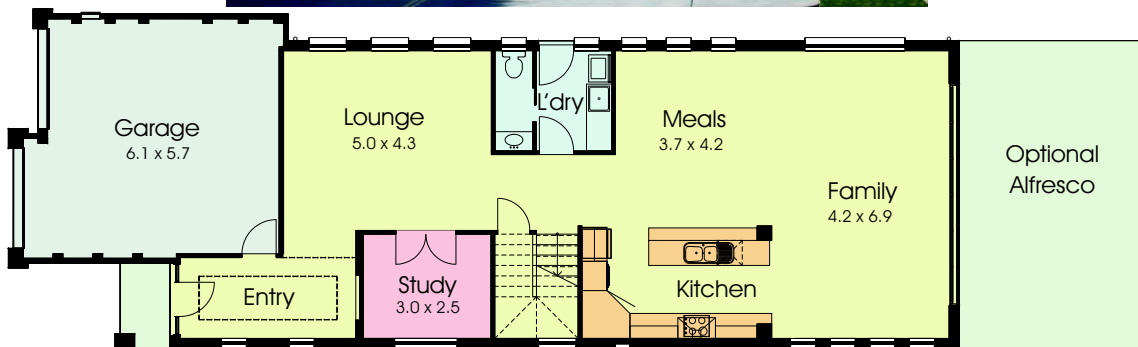

Ground Floor Plan

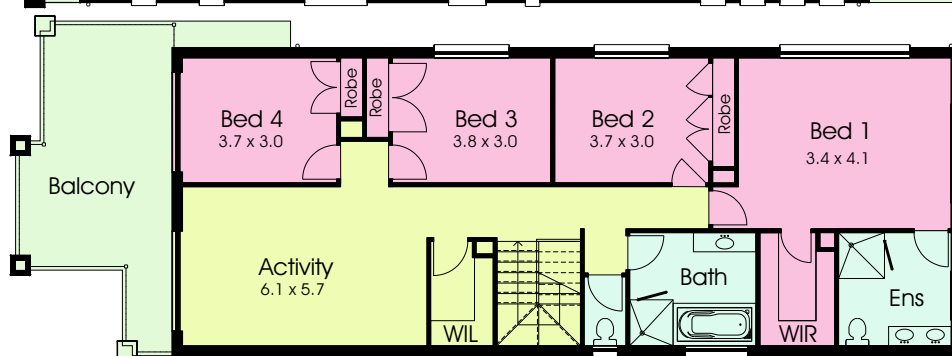

First Floor Plan

Designed to suit a narrow block The Hamilton provides a formal lounge which flows through to a large modern kitchen which overlooks the spacious family and meals room while providing the option of an outdoor alfresco area. The stairs deliver you to the bedrooms and an activity room which opens up onto the front balcony taking advantage of the views.
Width - 8.3m, Length - 27.3m.

- * 4 bedrooms plus a study
- * stylish kitchen overlooking large family / meals room
- * modern bathroom with separate WC
- * optional outdoor alfresco
- * built in robes to all bedrooms (walk in robe to the master bedroom)
- * double garage with internal access

Floor Area: 265.7sq.m (28.6sq) | Porch: 2.6sq.m | Garage: 36.3sq.m | Balcony: 24.5sq.m | Total: 329.1sq.m. (35.4sq) | (Optional Alfresco: 33.2sq.m)